



- LEGEND**
- URBAN MUNICIPALITIES
 - ▨ PRINCE ALBERT BOUNDARY
 - MAJOR HIGHWAY
 - DIVISION
 - ▨ RESERVE BOUNDARY
 - RURAL MUNICIPALITY BOUNDARY
- ZONING DISTRICTS**
- A - AGRICULTURAL
 - C1 - GENERAL COMMERCIAL
 - C2 - HIGHWAY COMMERCIAL
 - RMH - RESIDENTIAL MOBILE HOME
 - CR1 - LOW DENSITY COUNTRY RESIDENTIAL
 - CR2 - MEDIUM DENSITY COUNTRY RESIDENTIAL
 - CR3 - HIGH DENSITY COUNTRY RESIDENTIAL
 - CR4 - PREMIUM DENSITY COUNTRY RESIDENTIAL
 - H - HAMLET RESIDENTIAL
 - M - INDUSTRIAL
 - CON1 - CONSERVATION & ACTIVE RECREATION
 - CON2 - CONSERVATION & PASSIVE RECREATION

This is the Zoning District Map which accompanies Bylaw Number _____ adopted by the Rural Municipality of Prince Albert No. 461.

Reeve _____
 Administrator _____
 Approved on the ___ day of _____
 Minister of Government Relations _____

RURAL MUNICIPALITY OF PRINCE ALBERT ZONING DISTRICT MAP

SCALE NTS
 URBAN PLANNING AND DESIGN
 COMMUNITY PLANNING

DRAWING	REVISION	SHEET
	1	1

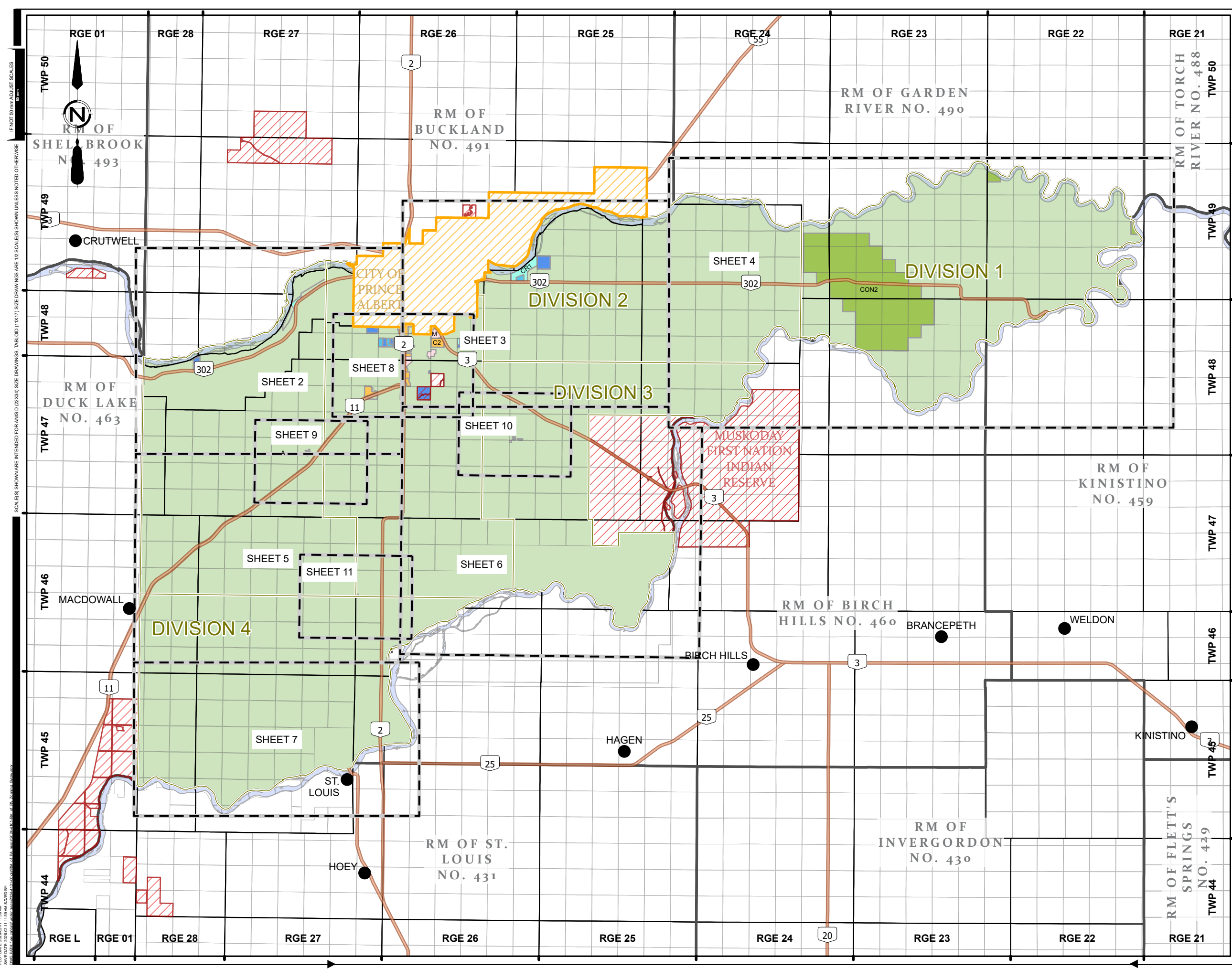

PLOT DATE: 2024-02-11 11:39 AM
 SAVE DATE: 2024-02-11 11:39 AM
 SCALE(S) SHOWN ARE INTENDED FOR ANS D (22x34) SIZE DRAWINGS. TABLED (11x17) SIZE DRAWINGS ARE 1/2 SCALE(S) SHOWN UNLESS NOTED OTHERWISE.
 IF NOT 50 mm ADJUST SCALES.



- LEGEND**
- URBAN MUNICIPALITIES
 - ▨ PRINCE ALBERT BOUNDARY
 - MAJOR HIGHWAY
 - - - DIVISION
 - ▨ RESERVE BOUNDARY
 - ▭ RURAL MUNICIPALITY BOUNDARY
 - LEGAL SURFACE
- ZONING DISTRICTS**
- A - AGRICULTURAL
 - C1 - GENERAL COMMERCIAL
 - C2 - HIGHWAY COMMERCIAL
 - RMH - RESIDENTIAL MOBILE HOME
 - CR1 - LOW DENSITY COUNTRY RESIDENTIAL
 - CR2 - MEDIUM DENSITY COUNTRY RESIDENTIAL
 - CR3 - HIGH DENSITY COUNTRY RESIDENTIAL
 - CR4 - PREMIUM DENSITY COUNTRY RESIDENTIAL
 - H - HAMLET RESIDENTIAL
 - M - INDUSTRIAL
 - CON1 - CONSERVATION & ACTIVE RECREATION
 - CON2 - CONSERVATION & PASSIVE RECREATION

This is the Zoning District Map which accompanies Bylaw Number _____ adopted by the Rural Municipality of Prince Albert No. 461.

Reeve _____
 Administrator _____
 Approved on the ___ day of _____
 Minister of Government Relations _____

RURAL MUNICIPALITY OF PRINCE ALBERT ZONING DISTRICT MAP

SCALE NTS
 URBAN PLANNING AND DESIGN
 COMMUNITY PLANNING

DRAWING	REVISION	SHEET
	1	2

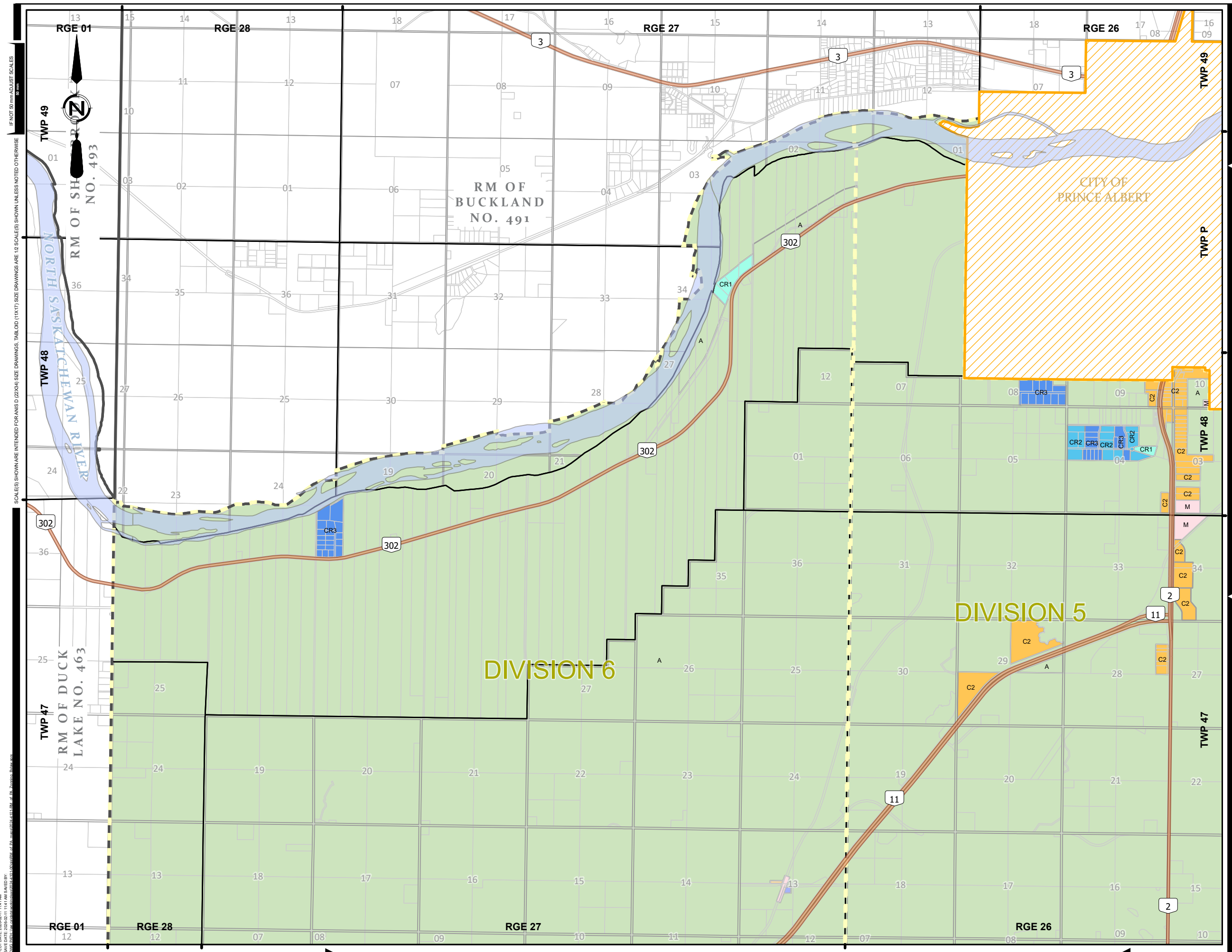

PLOT DATE: 2024-02-11 11:41 AM
 SAVE DATE: 2024-02-11 11:41 AM
 SCALE(S) SHOWN ARE INTENDED FOR A N D (22x34) SIZE DRAWINGS. TABLED (11x17) SIZE DRAWINGS ARE 1/2 SCALE(S) SHOWN UNLESS NOTED OTHERWISE.
 IF NOT 50 mm ADJUST SCALES
 50mm

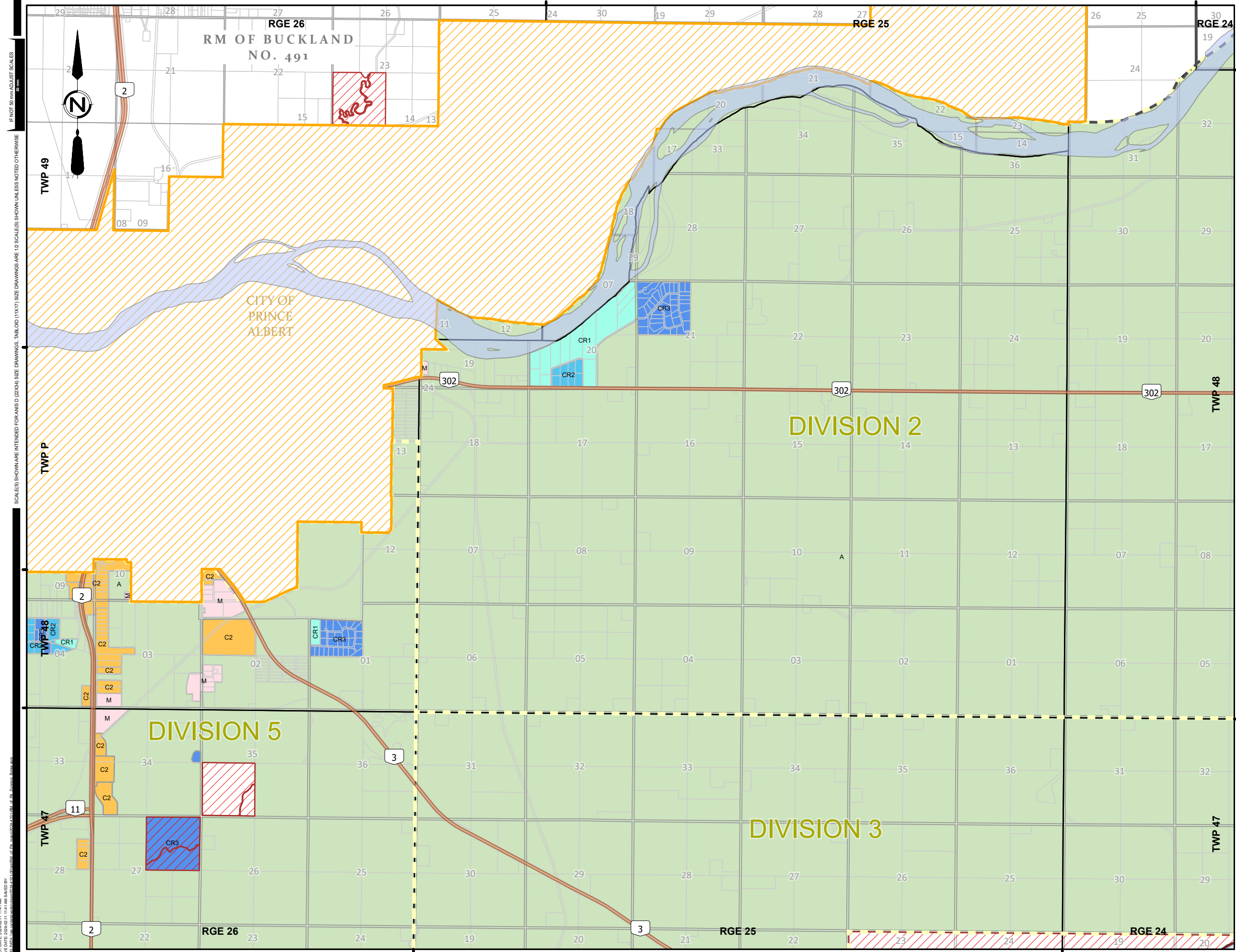

- LEGEND**
- URBAN MUNICIPALITIES
 - ▨ PRINCE ALBERT BOUNDARY
 - MAJOR HIGHWAY
 - ▨ DIVISION
 - ▨ RESERVE BOUNDARY
 - ▭ RURAL MUNICIPALITY BOUNDARY
 - LEGAL SURFACE
- ZONING DISTRICTS**
- A - AGRICULTURAL
 - C1 - GENERAL COMMERCIAL
 - C2 - HIGHWAY COMMERCIAL
 - RMH - RESIDENTIAL MOBILE HOME
 - CR1 - LOW DENSITY COUNTRY RESIDENTIAL
 - CR2 - MEDIUM DENSITY COUNTRY RESIDENTIAL
 - CR3 - HIGH DENSITY COUNTRY RESIDENTIAL
 - CR4 - PREMIUM DENSITY COUNTRY RESIDENTIAL
 - H - HAMLET RESIDENTIAL
 - M - INDUSTRIAL
 - CON1 - CONSERVATION & ACTIVE RECREATION
 - CON2 - CONSERVATION & PASSIVE RECREATION

This is the Zoning District Map which accompanies Bylaw Number _____ adopted by the Rural Municipality of Prince Albert No. 461.

Reeve _____
 Administrator _____
 Approved on the ___ day of _____
 Minister of Government Relations _____

RURAL MUNICIPALITY OF PRINCE ALBERT ZONING DISTRICT MAP

SCALE NTS
 URBAN PLANNING AND DESIGN
 COMMUNITY PLANNING

DRAWING	REVISION	SHEET
	1	3

PLOT DATE: 2024-02-11 11:41 AM
 SAVE DATE: 2024-02-11 11:41 AM
 SCALE(S) SHOWN ARE INTENDED FOR AINSD (22x34) SIZE DRAWINGS. TABLED (11x17) SIZE DRAWINGS ARE 1/2 SCALE(S) UNLESS NOTED OTHERWISE.
 IF NOT 50 mm ADJUST SCALES 25 mm.



- LEGEND**
- URBAN MUNICIPALITIES
 - ▨ PRINCE ALBERT BOUNDARY
 - MAJOR HIGHWAY
 - DIVISION
 - ▨ RESERVE BOUNDARY
 - ▭ RURAL MUNICIPALITY BOUNDARY
 - LEGAL SURFACE
- ZONING DISTRICTS**
- A - AGRICULTURAL
 - C1 - GENERAL COMMERCIAL
 - C2 - HIGHWAY COMMERCIAL
 - RMH - RESIDENTIAL MOBILE HOME
 - CR1 - LOW DENSITY COUNTRY RESIDENTIAL
 - CR2 - MEDIUM DENSITY COUNTRY RESIDENTIAL
 - CR3 - HIGH DENSITY COUNTRY RESIDENTIAL
 - CR4 - PREMIUM DENSITY COUNTRY RESIDENTIAL
 - H - HAMLET RESIDENTIAL
 - M - INDUSTRIAL
 - CON1 - CONSERVATION & ACTIVE RECREATION
 - CON2 - CONSERVATION & PASSIVE RECREATION

This is the Zoning District Map which accompanies Bylaw Number _____ adopted by the Rural Municipality of Prince Albert No. 461.

Reeve _____

Administrator _____

Approved on the ___ day of _____

Minister of Government Relations _____

RURAL MUNICIPALITY OF PRINCE ALBERT ZONING DISTRICT MAP

SCALE NTS

URBAN PLANNING AND DESIGN
COMMUNITY PLANNING

DRAWING	REVISION	SHEET
	1	4

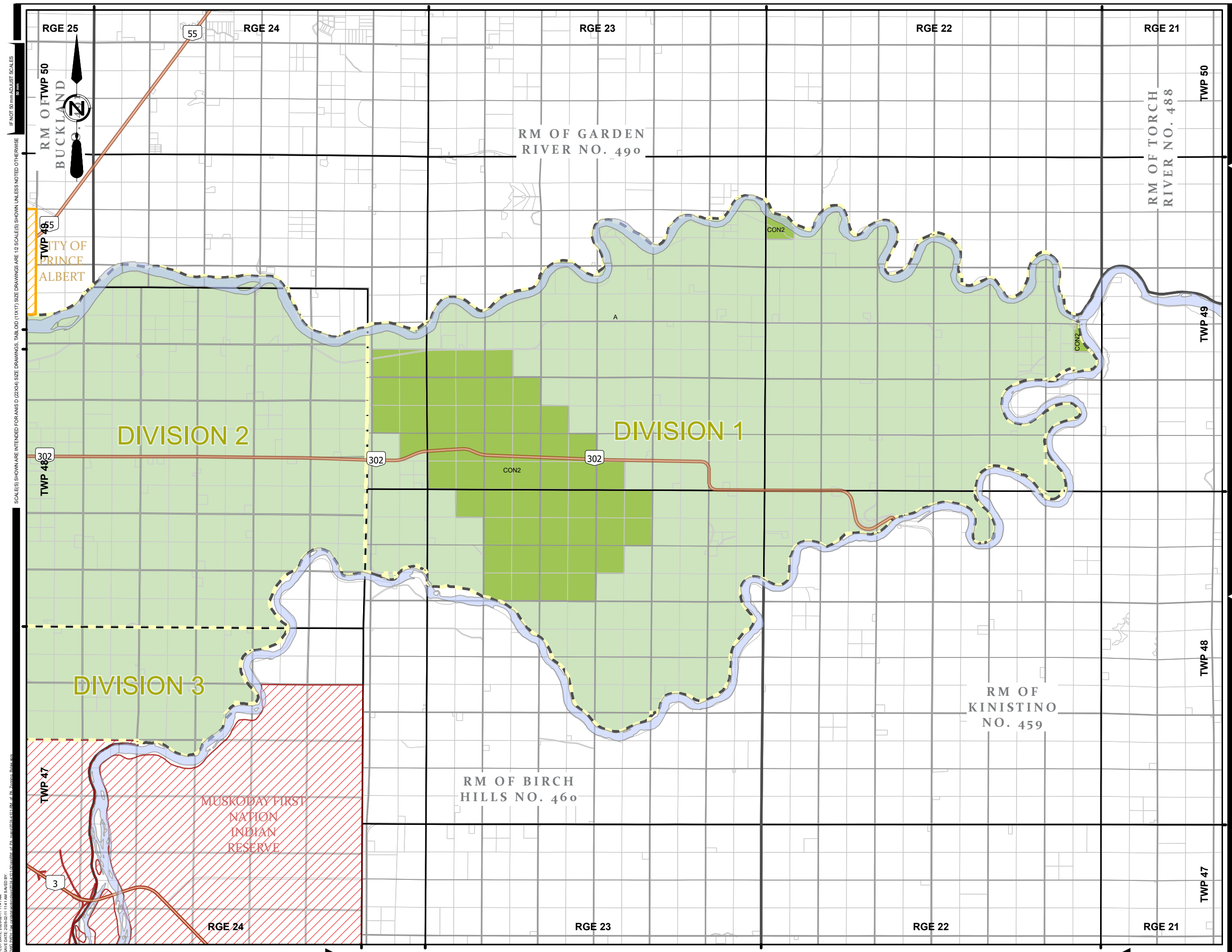

PLOT DATE: 2024-02-11 11:41 AM
 SAVE DATE: 2024-02-11 11:41 AM
 SCALE(S) SHOWN ARE INTENDED FOR A1S D (22x34) SIZE DRAWINGS. TABL01 (11x17) SIZE DRAWINGS ARE 1/2 SCALE(S) SHOWN UNLESS NOTED OTHERWISE.
 IF NOT 50 mm ADJUST SCALES.



- LEGEND**
- URBAN MUNICIPALITIES
 - ▭ PRINCE ALBERT BOUNDARY
 - MAJOR HIGHWAY
 - - - DIVISION
 - ▨ RESERVE BOUNDARY
 - ▭ RURAL MUNICIPALITY BOUNDARY
 - LEGAL SURFACE
- ZONING DISTRICTS**
- A - AGRICULTURAL
 - C1 - GENERAL COMMERCIAL
 - C2 - HIGHWAY COMMERCIAL
 - RMH - RESIDENTIAL MOBILE HOME
 - CR1 - LOW DENSITY COUNTRY RESIDENTIAL
 - CR2 - MEDIUM DENSITY COUNTRY RESIDENTIAL
 - CR3 - HIGH DENSITY COUNTRY RESIDENTIAL
 - CR4 - PREMIUM DENSITY COUNTRY RESIDENTIAL
 - H - HAMLET RESIDENTIAL
 - M - INDUSTRIAL
 - CON1 - CONSERVATION & ACTIVE RECREATION
 - CON2 - CONSERVATION & PASSIVE RECREATION

This is the Zoning District Map which accompanies Bylaw Number _____ adopted by the Rural Municipality of Prince Albert No. 461.

Reeve _____
 Administrator _____
 Approved on the ___ day of _____
 Minister of Government Relations _____

RURAL MUNICIPALITY OF PRINCE ALBERT ZONING DISTRICT MAP

SCALE NTS
 URBAN PLANNING AND DESIGN
 COMMUNITY PLANNING

DRAWING	REVISION	SHEET
	1	5

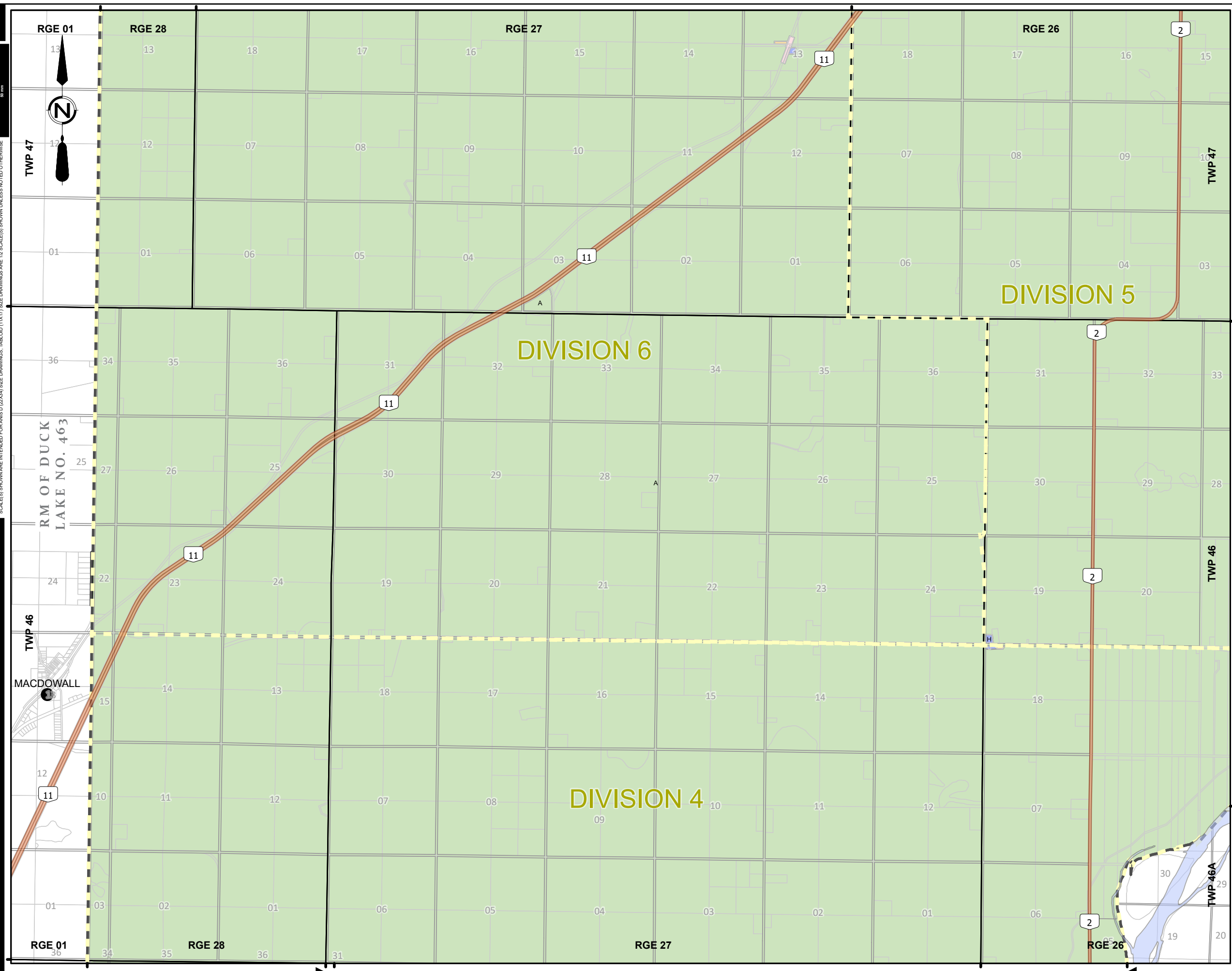

PLOT DATE: 2024-02-11 11:41 AM
 SAVE DATE: 2024-02-11 11:41 AM
 SCALE(S) SHOWN ARE INTENDED FOR A1S D (22x34) SIZE DRAWINGS, TABLED (11x17) SIZE DRAWINGS ARE 1/2 SCALE(S) SHOWN UNLESS NOTED OTHERWISE
 IF NOT 50 mm ADJUST SCALES
 50mm

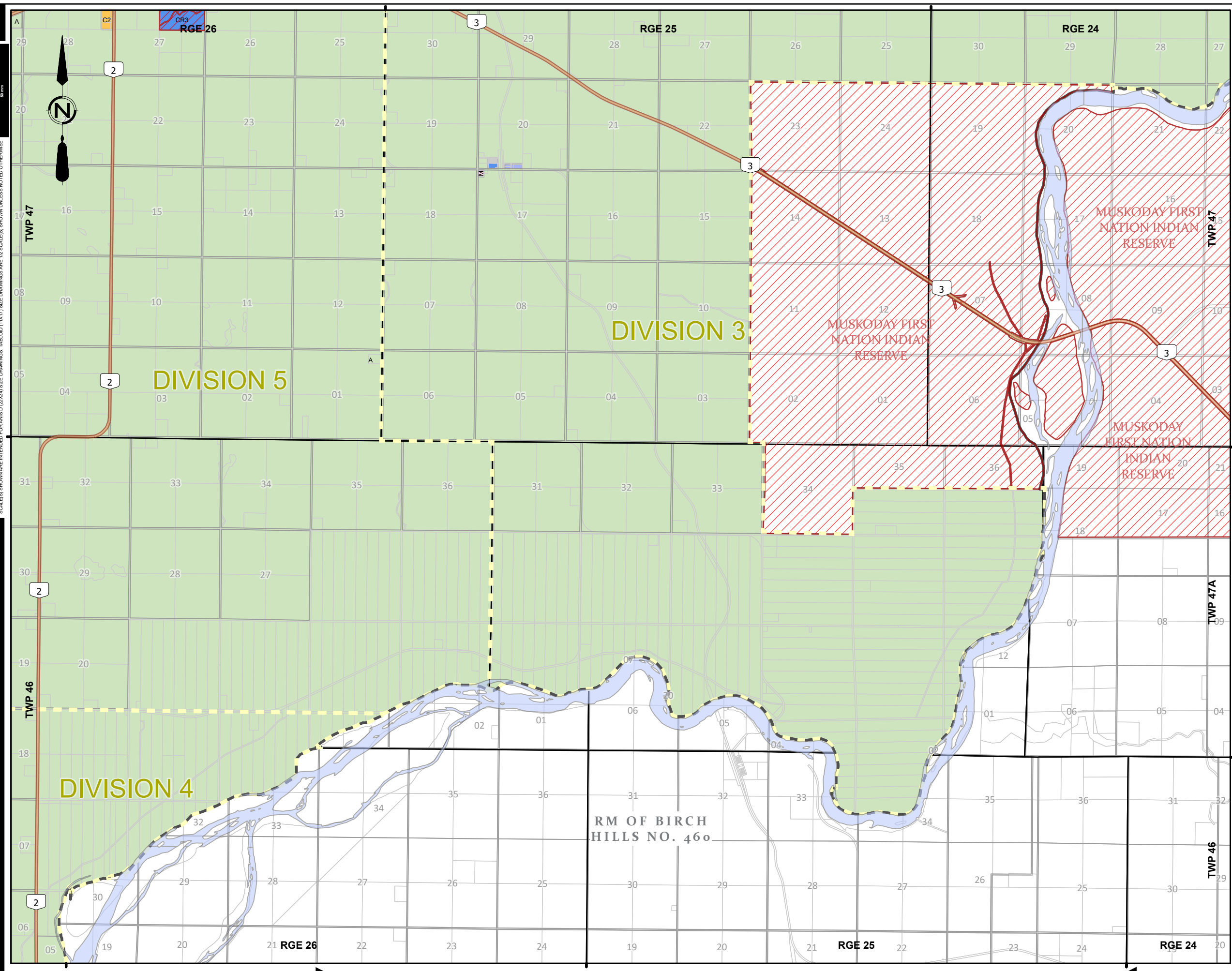

LEGEND

- URBAN MUNICIPALITIES
- ▭ PRINCE ALBERT BOUNDARY
- MAJOR HIGHWAY
- - - DIVISION
- ▨ RESERVE BOUNDARY
- ▭ RURAL MUNICIPALITY BOUNDARY
- ▭ LEGAL SURFACE
- ZONING DISTRICTS**
- ▭ A - AGRICULTURAL
- ▭ C1 - GENERAL COMMERCIAL
- ▭ C2 - HIGHWAY COMMERCIAL
- ▭ RMH - RESIDENTIAL MOBILE HOME
- ▭ CR1 - LOW DENSITY COUNTRY RESIDENTIAL
- ▭ CR2 - MEDIUM DENSITY COUNTRY RESIDENTIAL
- ▭ CR3 - HIGH DENSITY COUNTRY RESIDENTIAL
- ▭ CR4 - PREMIUM DENSITY COUNTRY RESIDENTIAL
- ▭ H - HAMLET RESIDENTIAL
- ▭ M - INDUSTRIAL
- ▭ CON1 - CONSERVATION & ACTIVE RECREATION
- ▭ CON2 - CONSERVATION & PASSIVE RECREATION

This is the Zoning District Map which accompanies Bylaw Number _____ adopted by the Rural Municipality of Prince Albert No. 461.

Reeve _____
 Administrator _____
 Approved on the ____ day of _____
 Minister of Government Relations _____

RURAL MUNICIPALITY OF PRINCE ALBERT ZONING DISTRICT MAP

SCALE NTS
 URBAN PLANNING AND DESIGN
 COMMUNITY PLANNING

DRAWING	REVISION	SHEET
	1	6

PLOT DATE: 2024-02-11 11:41 AM
 SAVE DATE: 2024-02-11 11:41 AM
 SCALE(S) SHOWN ARE INTENDED FOR A1S D (22x34) SIZE DRAWINGS. TABLED (11x17) SIZE DRAWINGS ARE 1/2 SCALE(S) SHOWN UNLESS NOTED OTHERWISE.
 IF NOT 50 mm ADJUST SCALES 1:25000

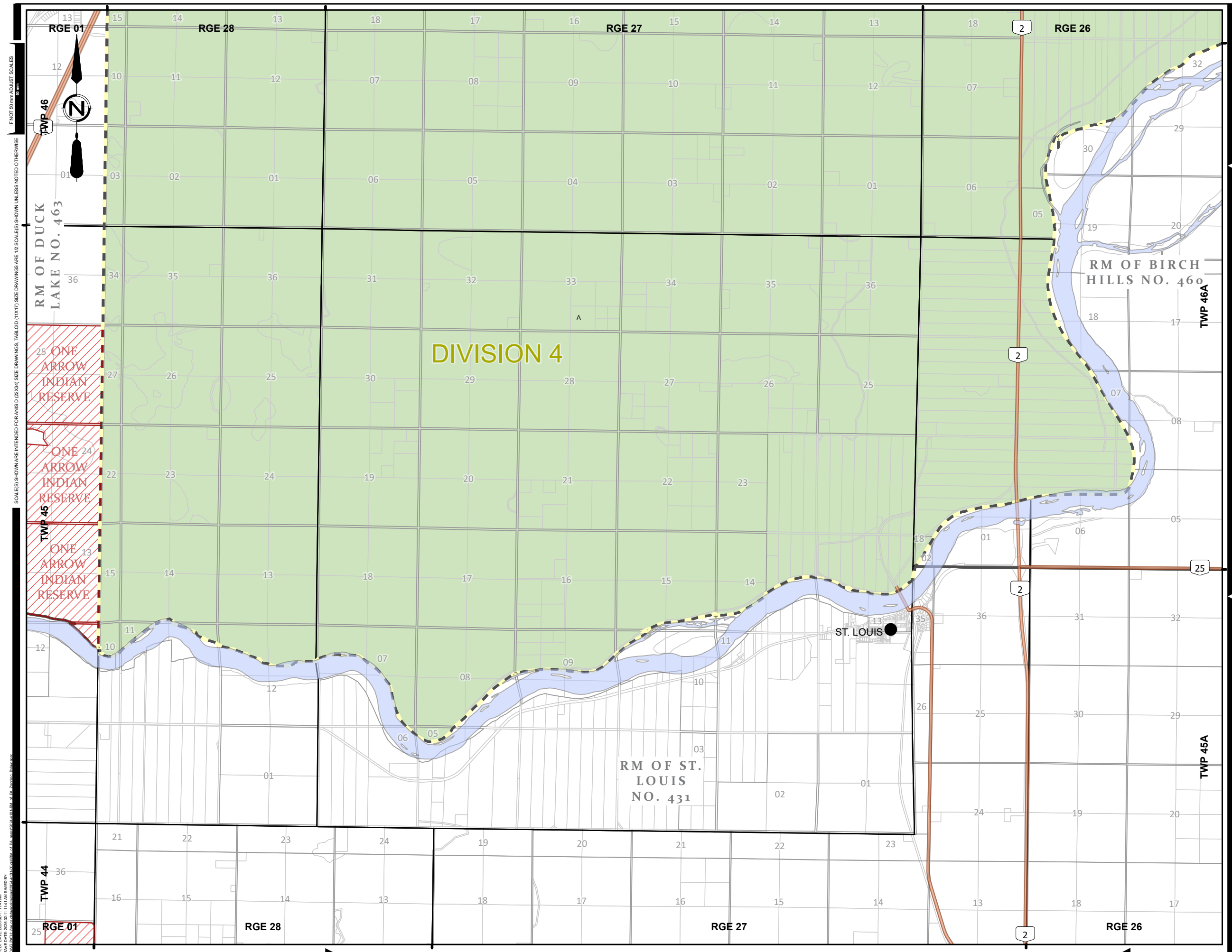

PLOT DATE: 2024-02-11 11:41 AM
 SAVE DATE: 2024-02-11 11:41 AM
 SCALE(S) SHOWN ARE INTENDED FOR ANS D (22x34) SIZE DRAWINGS. TABLOID (11x17) SIZE DRAWINGS ARE 1/2 SCALE(S) UNLESS NOTED OTHERWISE.
 IF NOT 50 mm ADJUST SCALES 1:25000



- LEGEND**
- URBAN MUNICIPALITIES
 - ▭ PRINCE ALBERT BOUNDARY
 - MAJOR HIGHWAY
 - - - DIVISION
 - ▭ RESERVE BOUNDARY
 - ▭ RURAL MUNICIPALITY BOUNDARY
 - ▭ LEGAL SURFACE
- ZONING DISTRICTS**
- A - AGRICULTURAL
 - C1 - GENERAL COMMERCIAL
 - C2 - HIGHWAY COMMERCIAL
 - RMH - RESIDENTIAL MOBILE HOME
 - CR1 - LOW DENSITY COUNTRY RESIDENTIAL
 - CR2 - MEDIUM DENSITY COUNTRY RESIDENTIAL
 - CR3 - HIGH DENSITY COUNTRY RESIDENTIAL
 - CR4 - PREMIUM DENSITY COUNTRY RESIDENTIAL
 - H - HAMLET RESIDENTIAL
 - M - INDUSTRIAL
 - CON1 - CONSERVATION & ACTIVE RECREATION
 - CON2 - CONSERVATION & PASSIVE RECREATION

This is the Zoning District Map which accompanies Bylaw Number _____ adopted by the Rural Municipality of Prince Albert No. 461.

Reeve _____

Administrator _____

Approved on the ___ day of _____

Minister of Government Relations _____

RURAL MUNICIPALITY OF PRINCE ALBERT ZONING DISTRICT MAP

SCALE NTS

URBAN PLANNING AND DESIGN
COMMUNITY PLANNING

DRAWING	REVISION	SHEET
	1	7

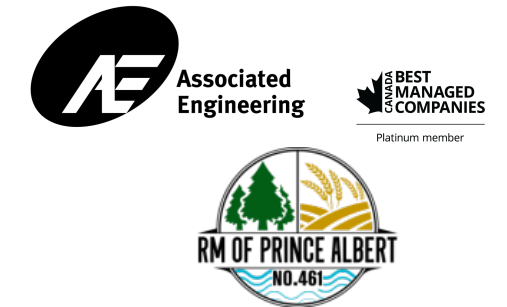
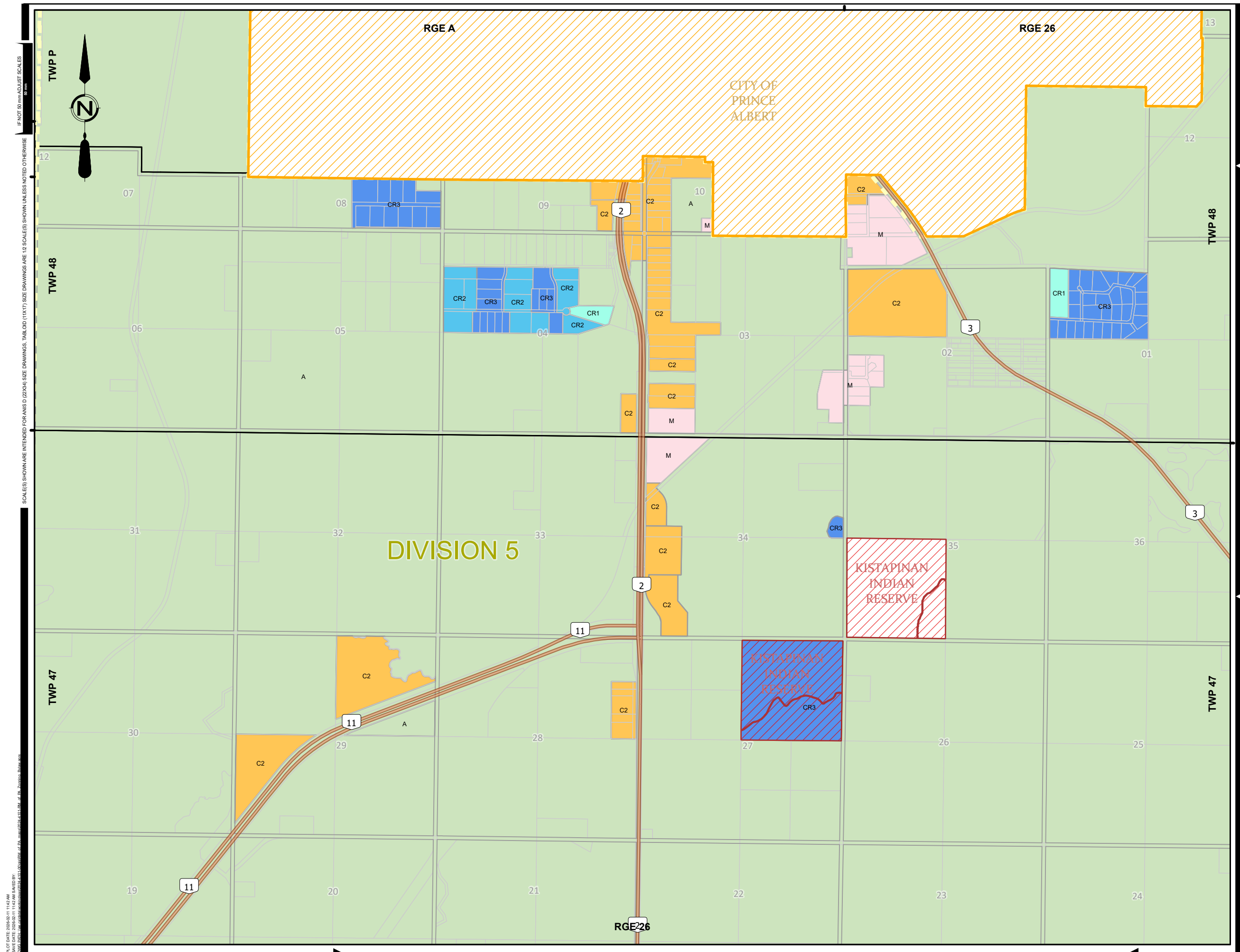

- LEGEND**
- URBAN MUNICIPALITIES
 - ▨ PRINCE ALBERT BOUNDARY
 - MAJOR HIGHWAY
 - ▨ DIVISION
 - ▨ RESERVE BOUNDARY
 - ▭ RURAL MUNICIPALITY BOUNDARY
 - LEGAL SURFACE
- ZONING DISTRICTS**
- A - AGRICULTURAL
 - C1 - GENERAL COMMERCIAL
 - C2 - HIGHWAY COMMERCIAL
 - RMH - RESIDENTIAL MOBILE HOME
 - CR1 - LOW DENSITY COUNTRY RESIDENTIAL
 - CR2 - MEDIUM DENSITY COUNTRY RESIDENTIAL
 - CR3 - HIGH DENSITY COUNTRY RESIDENTIAL
 - CR4 - PREMIUM DENSITY COUNTRY RESIDENTIAL
 - H - HAMLET RESIDENTIAL
 - M - INDUSTRIAL
 - CON1 - CONSERVATION & ACTIVE RECREATION
 - CON2 - CONSERVATION & PASSIVE RECREATION

This is the Zoning District Map which accompanies Bylaw Number _____ adopted by the Rural Municipality of Prince Albert No. 461.

Reeve _____

Administrator _____

Approved on the ___ day of _____

Minister of Government Relations _____

RURAL MUNICIPALITY OF PRINCE ALBERT ZONING DISTRICT MAP

SCALE NTS

URBAN PLANNING AND DESIGN
COMMUNITY PLANNING

DRAWING	REVISION	SHEET
	1	8

PLOT DATE: 2024-02-11 11:42 AM
 SAVE DATE: 2024-02-11 11:42 AM
 SCALE(S) SHOWN ARE INTENDED FOR ANS D (22X34) SIZE DRAWINGS. TABLED (11X17) SIZE DRAWINGS ARE 1/2 SCALE(S) SHOWN UNLESS NOTED OTHERWISE.
 IF NOT 50 mm ADJUST SCALES 50mm

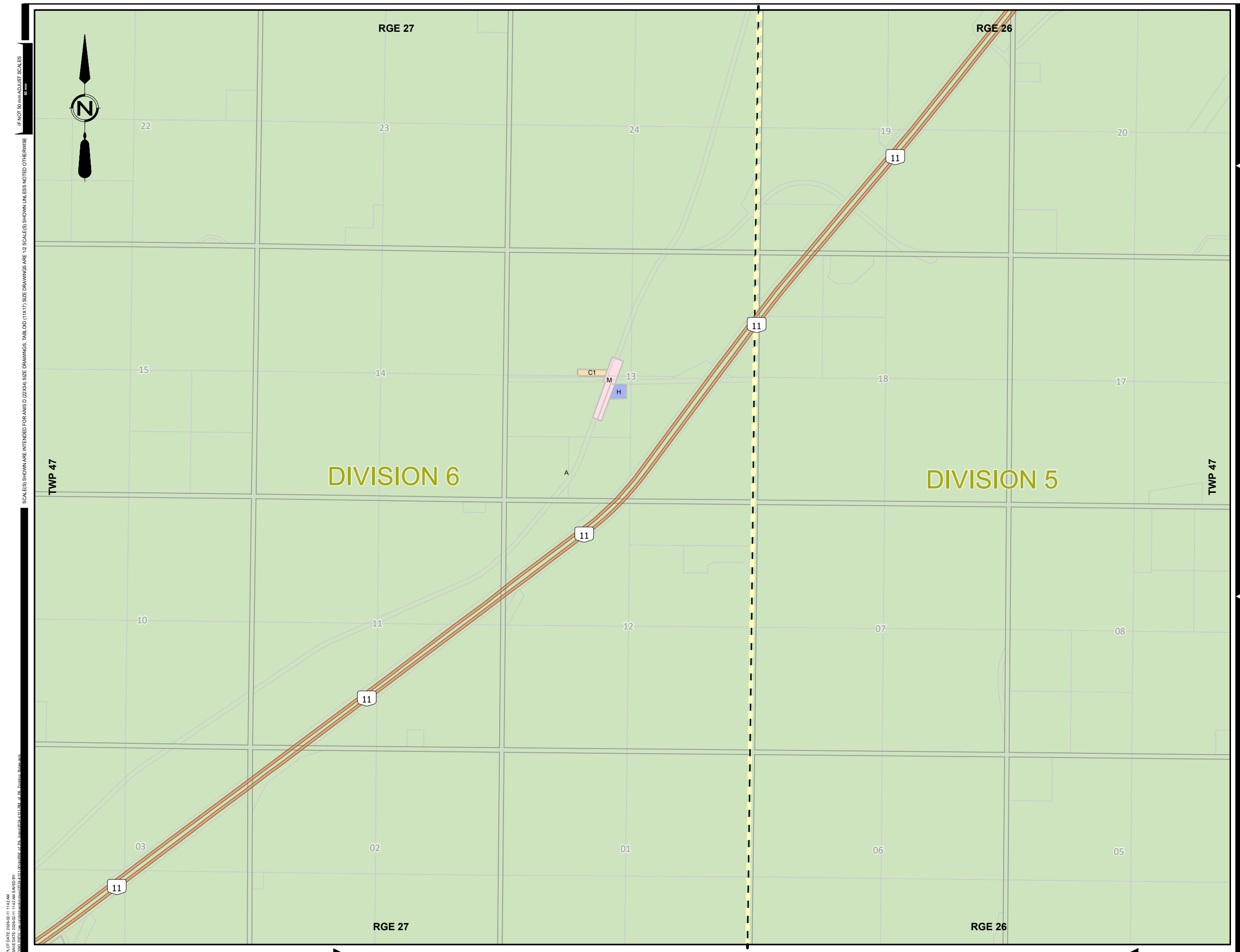

PLOT DATE: 2024-02-11 11:42 AM
 SAVE DATE: 2024-02-11 11:42 AM
 SCALE(S) SHOWN ARE INTENDED FOR ANS D (22x34) SIZE DRAWINGS. TABLOID (11x17) SIZE DRAWINGS ARE 1/2 SCALE(S) SHOWN UNLESS NOTED OTHERWISE.
 IF NOT 50 mm ADJUST SCALES 2.5mm

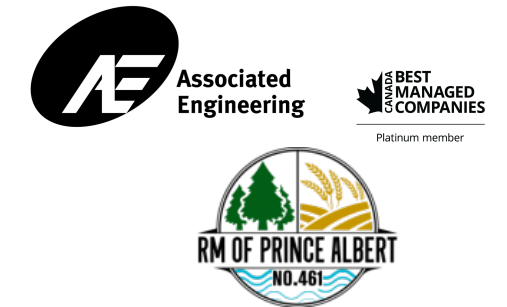

- LEGEND**
- URBAN MUNICIPALITIES
 - ▨ PRINCE ALBERT BOUNDARY
 - MAJOR HIGHWAY
 - ▨ DIVISION
 - ▨ RESERVE BOUNDARY
 - ▭ RURAL MUNICIPALITY BOUNDARY
 - LEGAL SURFACE
- ZONING DISTRICTS**
- A - AGRICULTURAL
 - C1 - GENERAL COMMERCIAL
 - C2 - HIGHWAY COMMERCIAL
 - RMH - RESIDENTIAL MOBILE HOME
 - CR1 - LOW DENSITY COUNTRY RESIDENTIAL
 - CR2 - MEDIUM DENSITY COUNTRY RESIDENTIAL
 - CR3 - HIGH DENSITY COUNTRY RESIDENTIAL
 - CR4 - PREMIUM DENSITY COUNTRY RESIDENTIAL
 - H - HAMLET RESIDENTIAL
 - M - INDUSTRIAL
 - CON1 - CONSERVATION & ACTIVE RECREATION
 - CON2 - CONSERVATION & PASSIVE RECREATION

This is the Zoning District Map which accompanies Bylaw Number _____ adopted by the Rural Municipality of Prince Albert No. 461.

Reeve

Administrator

Approved on the ___ day of _____

Minister of Government Relations

**RURAL MUNICIPALITY OF PRINCE ALBERT
ZONING DISTRICT MAP**

SCALE NTS

URBAN PLANNING AND DESIGN
COMMUNITY PLANNING

DRAWING	REVISION	SHEET
	1	9



- LEGEND**
- URBAN MUNICIPALITIES
 - ▨ PRINCE ALBERT BOUNDARY
 - MAJOR HIGHWAY
 - ▨ DIVISION
 - ▨ RESERVE BOUNDARY
 - ▭ RURAL MUNICIPALITY BOUNDARY
 - LEGAL SURFACE
- ZONING DISTRICTS**
- A - AGRICULTURAL
 - C1 - GENERAL COMMERCIAL
 - C2 - HIGHWAY COMMERCIAL
 - RMH - RESIDENTIAL MOBILE HOME
 - CR1 - LOW DENSITY COUNTRY RESIDENTIAL
 - CR2 - MEDIUM DENSITY COUNTRY RESIDENTIAL
 - CR3 - HIGH DENSITY COUNTRY RESIDENTIAL
 - CR4 - PREMIUM DENSITY COUNTRY RESIDENTIAL
 - H - HAMLET RESIDENTIAL
 - M - INDUSTRIAL
 - CON1 - CONSERVATION & ACTIVE RECREATION
 - CON2 - CONSERVATION & PASSIVE RECREATION

This is the Zoning District Map which accompanies Bylaw Number _____ adopted by the Rural Municipality of Prince Albert No. 461.

Reeve _____

Administrator _____

Approved on the ___ day of _____

Minister of Government Relations _____

**RURAL MUNICIPALITY OF PRINCE ALBERT
ZONING DISTRICT MAP**

SCALE NTS

URBAN PLANNING AND DESIGN
COMMUNITY PLANNING

DRAWING	REVISION	SHEET
	1	10

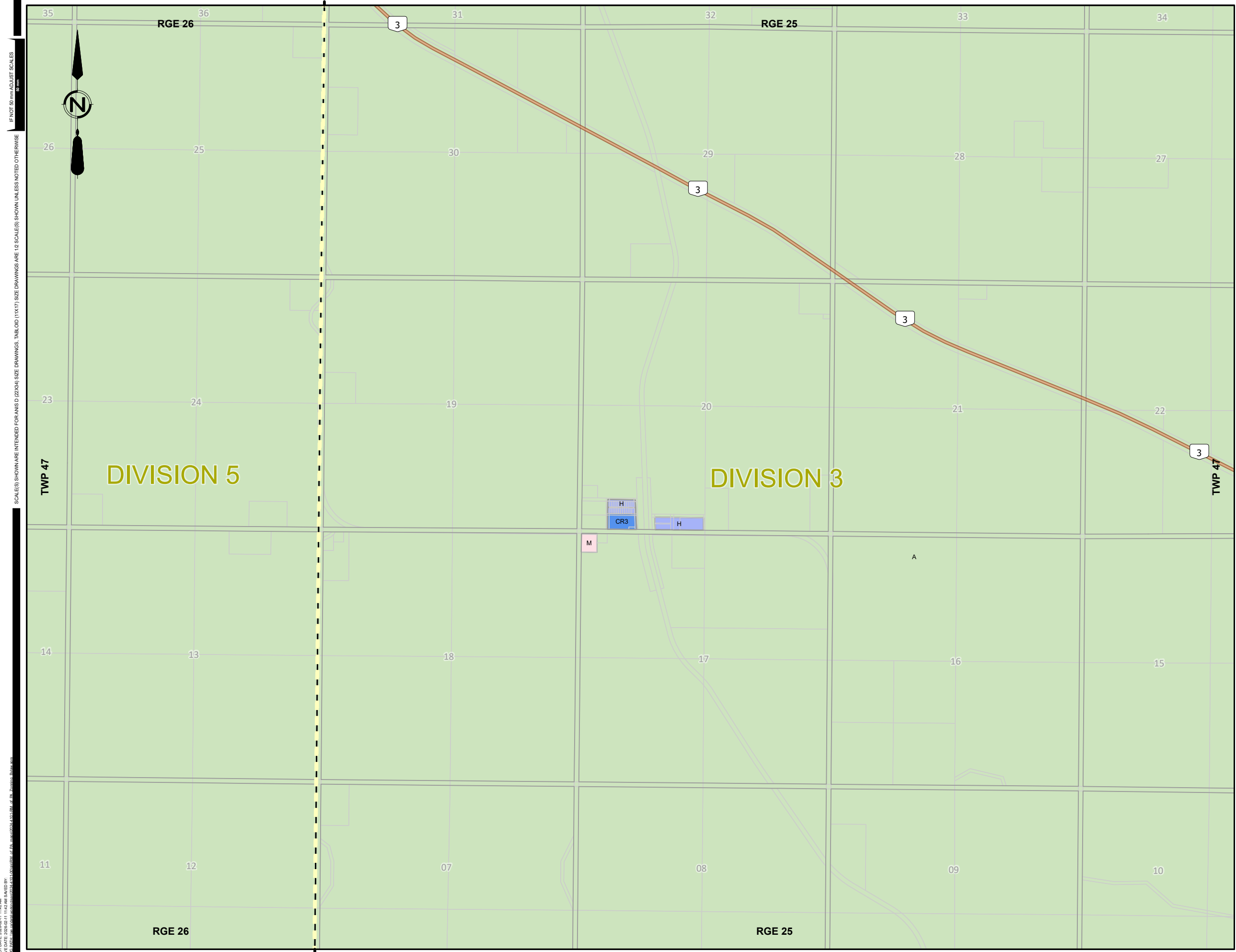

PLOT DATE: 2024-02-11 11:42 AM
 SAVE DATE: 2024-02-11 11:42 AM
 SCALE(S) SHOWN ARE INTENDED FOR A1S D (22X34) SIZE DRAWINGS, TABLOID (11X17) SIZE DRAWINGS ARE 1/2 SCALE(S) SHOWN UNLESS NOTED OTHERWISE
 IF NOT 50 mm ADJUST SCALES
 2 mm

PLOT DATE: 2024-02-11 11:42 AM
 SAVE DATE: 2024-02-11 11:42 AM
 SCALE(S) SHOWN ARE INTENDED FOR ANS D (22X34) SIZE DRAWINGS. TABLED (11X17) SIZE DRAWINGS ARE 1/2 SCALE(S) SHOWN UNLESS NOTED OTHERWISE.
 IF NOT 50 mm ADJUST SCALES 29mm

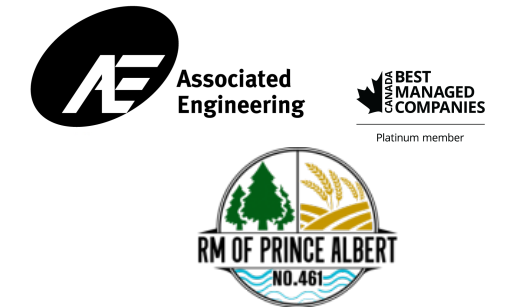
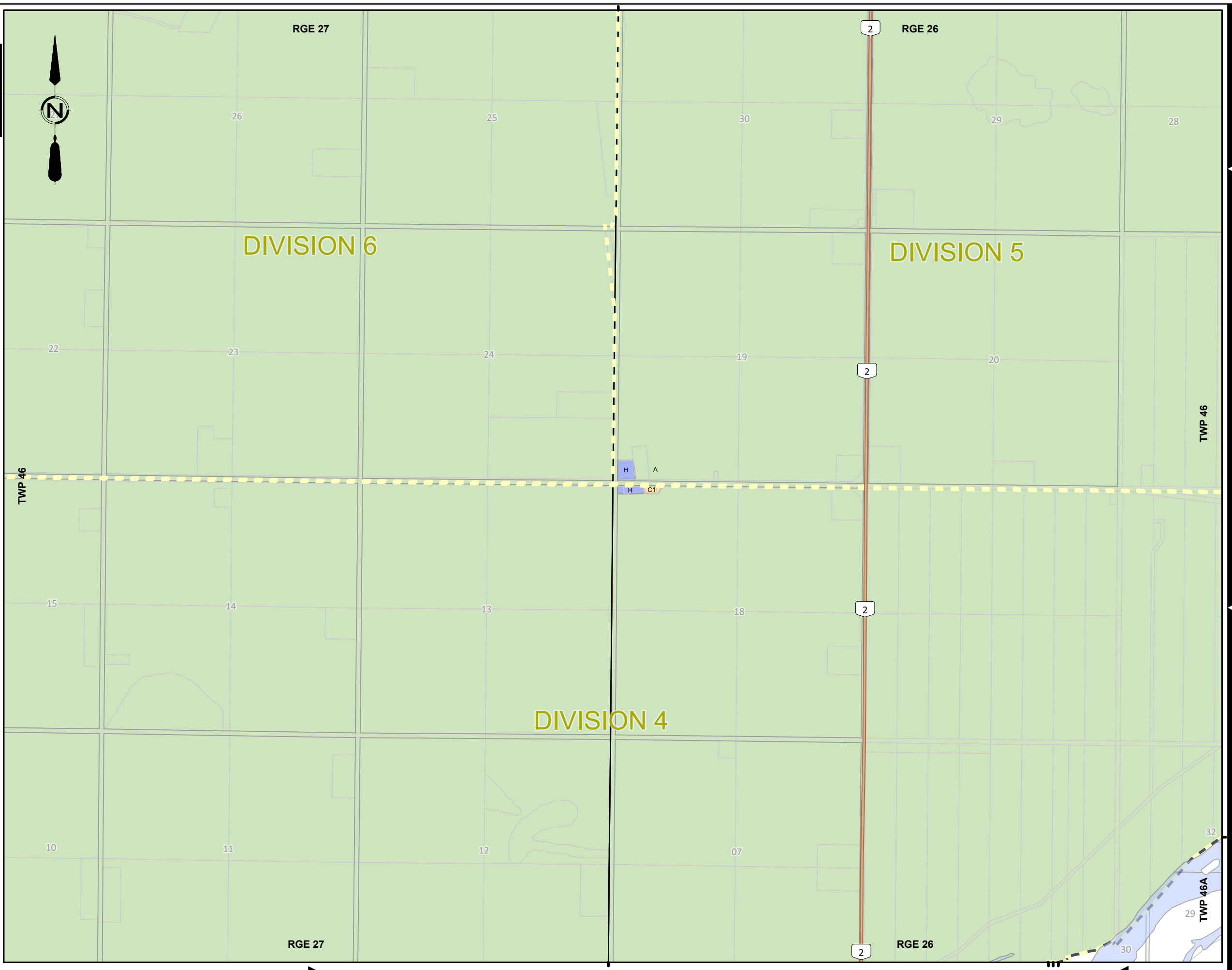

- LEGEND**
- URBAN MUNICIPALITIES
 - ▨ PRINCE ALBERT BOUNDARY
 - MAJOR HIGHWAY
 - ▨ DIVISION
 - ▨ RESERVE BOUNDARY
 - ▭ RURAL MUNICIPALITY BOUNDARY
 - LEGAL SURFACE
- ZONING DISTRICTS**
- A - AGRICULTURAL
 - C1 - GENERAL COMMERCIAL
 - C2 - HIGHWAY COMMERCIAL
 - RMH - RESIDENTIAL MOBILE HOME
 - CR1 - LOW DENSITY COUNTRY RESIDENTIAL
 - CR2 - MEDIUM DENSITY COUNTRY RESIDENTIAL
 - CR3 - HIGH DENSITY COUNTRY RESIDENTIAL
 - CR4 - PREMIUM DENSITY COUNTRY RESIDENTIAL
 - H - HAMLET RESIDENTIAL
 - M - INDUSTRIAL
 - CON1 - CONSERVATION & ACTIVE RECREATION
 - CON2 - CONSERVATION & PASSIVE RECREATION

This is the Zoning District Map which accompanies Bylaw Number _____ adopted by the Rural Municipality of Prince Albert No. 461.

Reeve

Administrator

Approved on the ___ day of _____

Minister of Government Relations

**RURAL MUNICIPALITY OF PRINCE ALBERT
ZONING DISTRICT MAP**

SCALE NTS

URBAN PLANNING AND DESIGN
COMMUNITY PLANNING

DRAWING	REVISION	SHEET
	1	11